



Selection Criteria

Application

Food & Beverage, steam irons, carpet washers, medical and dental appliances, drink dispensers, water gasifiers, smoke machines, ari conditioners.

Special Features

- NSF approved: Food Contact
- UL and VDE approval
- 100% tested, each pump bears these information:
 - Date: day; months; year
 - Serial number
 - Production batch

That proving that is has passed the test and allo wing traceability.



CONSTRUCTION

The main construction components of the pumps of the SP000 series are:

- Coil, II isolation class
- Reinforcement/Bushers: treated steel
- Pump body: polyamide fiber glass reinforced
- Gasket: NBR
- Core: stainless steel
- Springs: stainless steel
- Sealing ball: Nylon

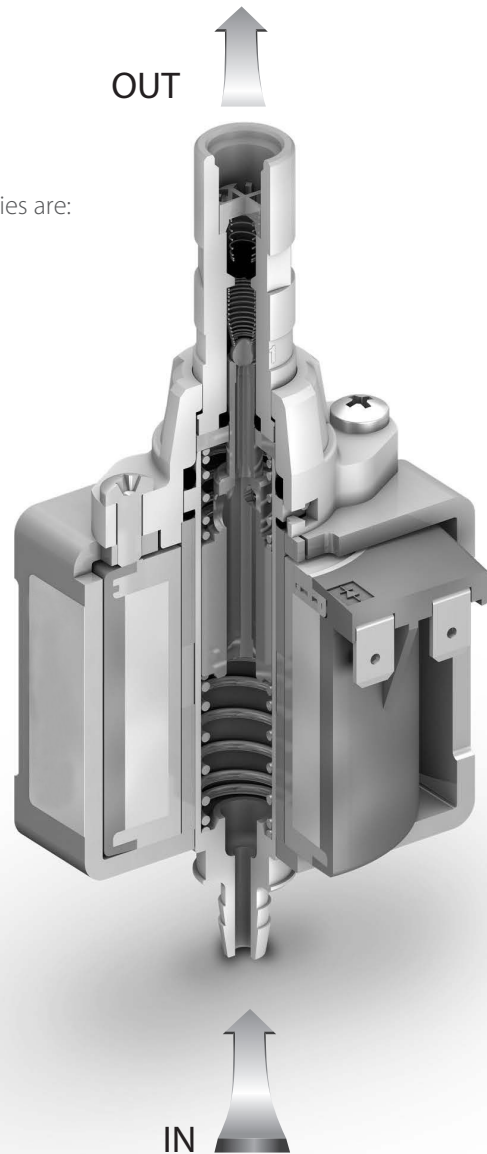

GENERAL FEATURES

In this type of pump, the fluid inside the vibration pump flows due to vibration of the plunger which is plunged into the magnetic field generated by the coil. Compression and depression alternate due to this vibration inside the pump which results in a pumping action.

The pump is of the self-priming type but is not suitable for dry operation or for pumping when back pressures are present on the outlet side.

The piston (that moves alternatively at the same supply frequency) enables a passive suction travel during the electromagnetic active phase and an active thrust travel of the fluid during the electromagnetic passive phase.

The pump is provided with an integrated diode, and the external casing is equipped with a special pocket for thermoprotective devices.

I CERTIFICATIONS





COIL TAG READING

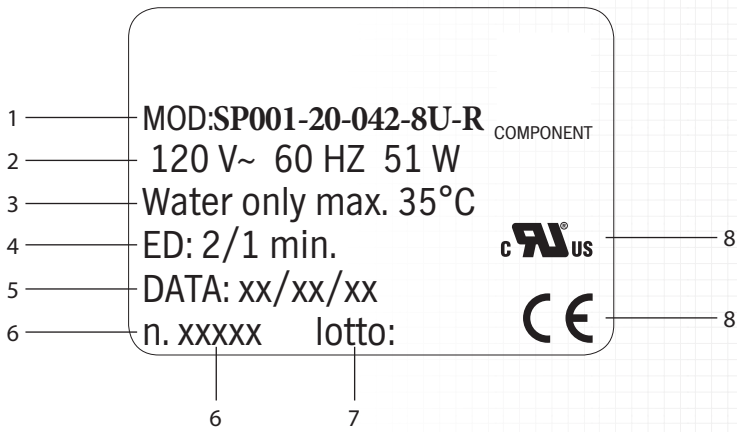

- 1- Model
- 2- Voltage
- 3- Max temperature of fluid
- 4- Duty cycle
- 5- Date test
- 6- Batch sequence number
- 7- Batch number
- 8 - Approval

43 PSI

SP000-03-120-1-R

Self-priming vibration pumps made of plastic

SP001-03-120-1-R

Self-priming vibration pumps made of brass

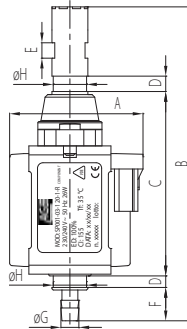

Code	DIMENSIONS							
	A [mm]	B [mm]	C [mm]	D [mm]	E [mm]	F [mm]	ØG [mm]	ØH [mm]
SP000	52	123	73.4	4.5	6	13	7	13

CODING SCHEME

SP00X		-	XX	-	XXX	-	XX	-	X
Family			[Psi]		Flow Rate [cc/min]		Coil		Seal
SP000	Foodstuff NBR versions		43		120 1200		003		R O-ring
Plastic components					Flow Rate [oz/min]		230-240Vac 50Hz 26W		
SP001					4.05		03G		
OT57(CW510L) brass end							230-240Vac 50Hz 26W with "Glow Wire" VDE type approval		
SP002							06U		
Plastic end + brass bush							120Vac 60Hz 29W with UL approval		Other voltage upon request

- PRESSURE AND FLOW RATE DIAGRAM

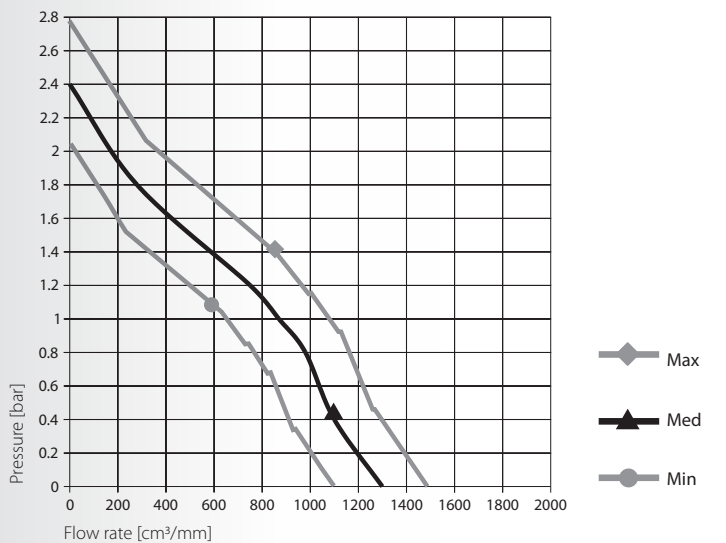



58 PSI

SP000-04-095-9-R

Self-priming vibration pumps made of plastic

SP001-04-095-9-R

Self-priming vibration pumps made of brass

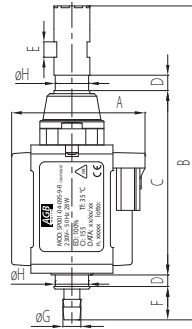

Code	DIMENSIONS							
	A [mm]	B [mm]	C [mm]	D [mm]	E [mm]	F [mm]	ØG [mm]	ØH [mm]
SP000	52	123	73.4	4.5	6	13	7	13

SCHEMA DI CODIFICA - CODING SCHEME

SP00X	-	XX	-	XXX	-	XX	-	X
Family		[Psi]		Flow Rate [cc/min]		Coil		Seal
SP000		58		095 950		009		R O-ring
Plastic components				Flow Rate [oz/min]		230Vac 50Hz 28W		
SP001				3.2		09G		
TOTS7(CW510L) brass end						120Vac 60Hz 27W with UL approval		
SP002						Other voltage upon request		
Plastic end + brass bush								

PRESSURE AND FLOW RATE DIAGRA

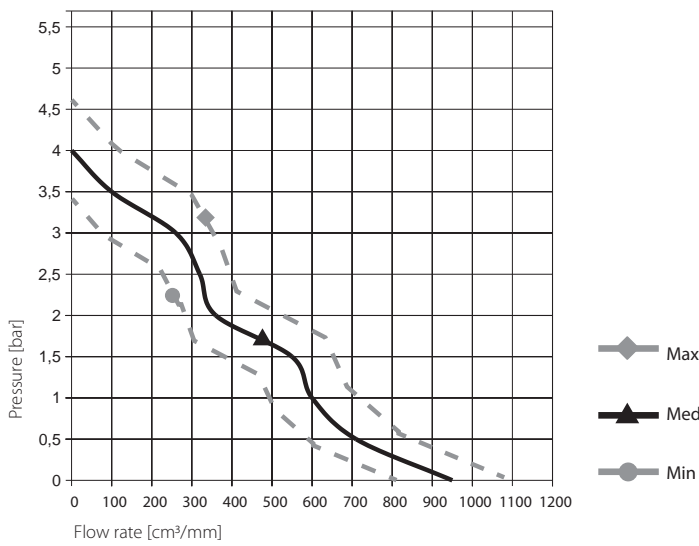

101 PSI

SP000-07-100-1-R

Self-priming vibration pumps made of plastic

SP001-07-100-1-R

Self-priming vibration pumps made of brass

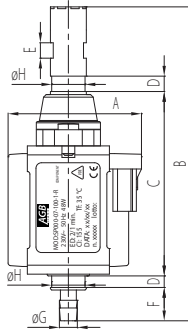

Code	DIMENSIONS							
	A [mm]	B [mm]	C [mm]	D [mm]	E [mm]	F [mm]	ØG [mm]	ØH [mm]
SP000	52	123	73.4	4.5	6	13	7	13

CODING SCHEME

SP00X	-	XX	-	XXX	-	XX	-	X
Family		Pmax [Psi]		Flow Rate [cc/min]		Coil		Seal
SP000		101		100 1000		001		R O-ring
Plastic components	Foodstuff/NBR versions			Flow Rate [oz/min]		230Vac 50Hz 48W		
SP001				3.38		01G		
OT57(CW510L) brass end						230Vac 50Hz 48W with "Glow Wire" VDE type approval		
SP002						08U		
Plastic end + brass bush						120Vac 60Hz 51W with UL approval		Other voltage upon request

PRESSURE AND FLOW RATE DIAGRAM

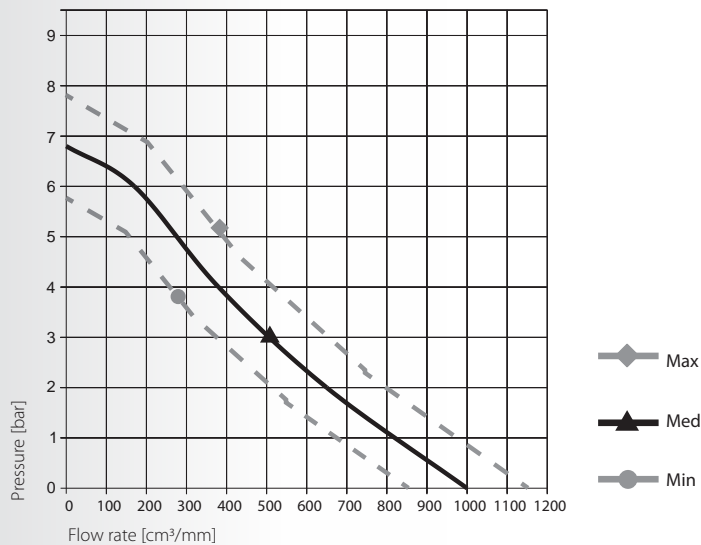



217 PSI

SP000-15-065-1-R

Self-priming vibration pumps made of plastic

SP001-15-065-1-R

Self-priming vibration pumps made of brass

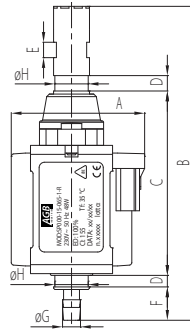

Code	DIMENSIONS							
	A [mm]	B [mm]	C [mm]	D [mm]	E [mm]	F [mm]	ØG [mm]	ØH [mm]
SP000	52	123	73.4	4.5	6	13	7	13

CODING SCHEME

SP00X	-	XX	-	XXX	-	XX	-	X
Family		[Psi]		Flow Rate [cc/min]		Coil		Seal
SP000 Plastic components	Foodstuff NBR versions	217		065 650		001 230Vac 50Hz 48W		R O-ring
SP001 OT57(CW510L) brass end				2.19		01G 120Vac 60Hz 27W with UL approval		
SP002 Plastic end + brass bush						08U 120Vac 60Hz 51W with UL approval		
							Other voltage upon request	

PRESSURE AND FLOW RATE DIAGRA

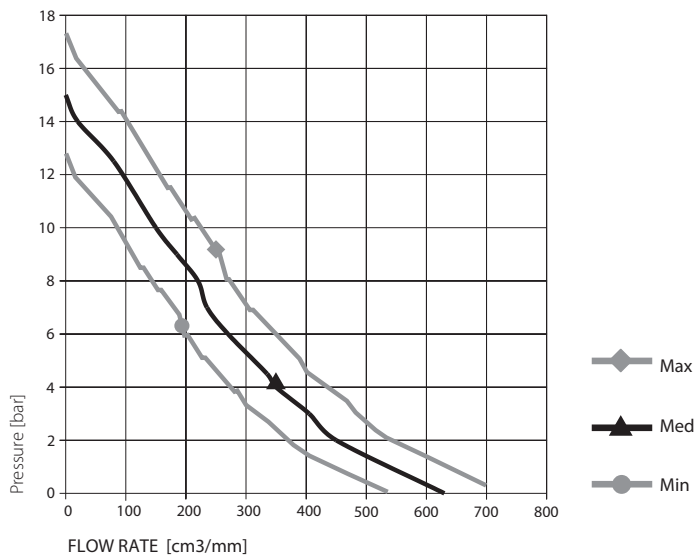

290 PSI

SP000-20-042-1-R

Self-priming vibration pumps made of plastic

SP001-20-042-1-R

Self-priming vibration pumps made of brass

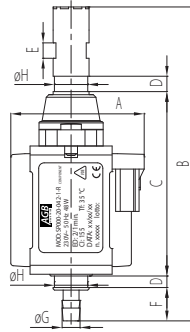

Code	DIMENSIONS							
	A [mm]	B [mm]	C [mm]	D [mm]	E [mm]	F [mm]	ØG [mm]	ØH [mm]
SP000	52	123	73.4	4.5	6	13	7	13

CODING SCHEME

SP00X		-	XX	-	XXX	-	XX	-	X
Family			[Psi]		Flow Rate [cc/min]		Coil		Seal
SP000	Foodstuff NBR versions		290		042 420		001		R O-ring
Plastic components					Flow Rate [cc/min]		230Vac 50Hz 48W		
SP001					1.4		01G		
T OT57(CW510L) brass end							230Vac 50Hz 48W with "Glow Wire" VDE type approval		
SP002						08U			
Plastic end + brass bush						120Vac 60Hz 51W with UL approval		Other voltage upon request	

PRESSURE AND FLOW RATE DIAGRAM

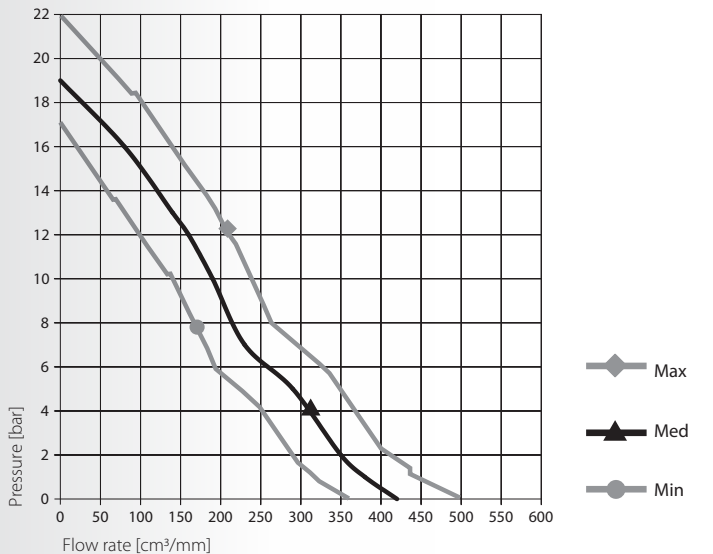

ACCESSORIES

SP000/AM03

THERMOPROTECTOR
 A device for cutting off power supply to the pump during abnormal operation
 Available with different operating temperatures as according to the table below

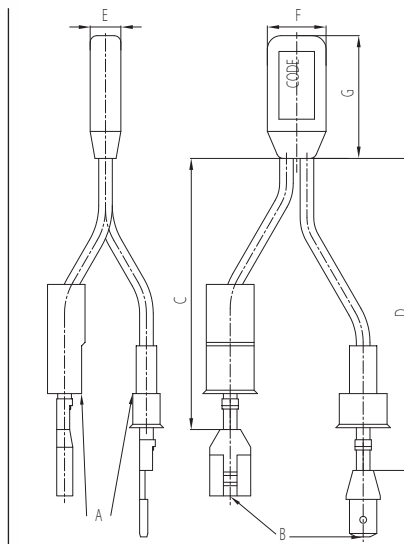

Code	DIMENSIONS						
	A	B	C [mm]	D [mm]	E [mm]	F [mm]	G [mm]
SP000/AM03-110	Male and female cover Faston	Male and female faston 6.3x0.8	70	90	4.5- ⁰ / _{0.7}	8.6±0.5	18- ⁰ / _{1.5}
SP000/AM03-120							

Code	Temperature [°F]	Versions
SP000/AM03-110	176°F – VDE approval	Standard
SP000/AM03-120	194°F – VDE approval	Standard

ACCESSORIES

SP000/23

PVC 70ShA rubber support for vibration pumps **SP000 - SP001** series
 Pump mounting support for damping

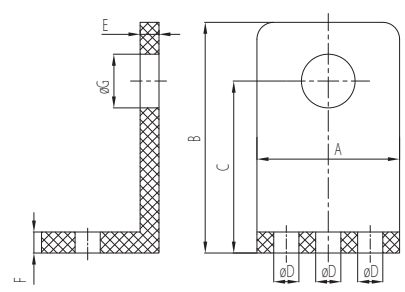

Code	DIMENSIONS						
	A [mm]	B [mm]	C [mm]	ØD [mm]	E [mm]	F [mm]	ØG [mm]
SP000/23-P	34	55	41	6	4.5	5	12.8

Code	Material	Suggested application
SP000/23-P	PVC 70 Sh.A	For temperatures $T < 122^{\circ} F$

NB: - 2pcs for each pump